

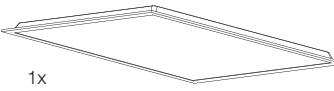









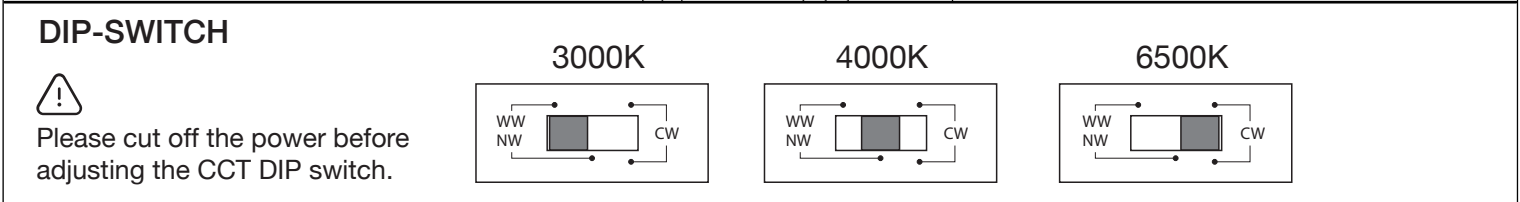
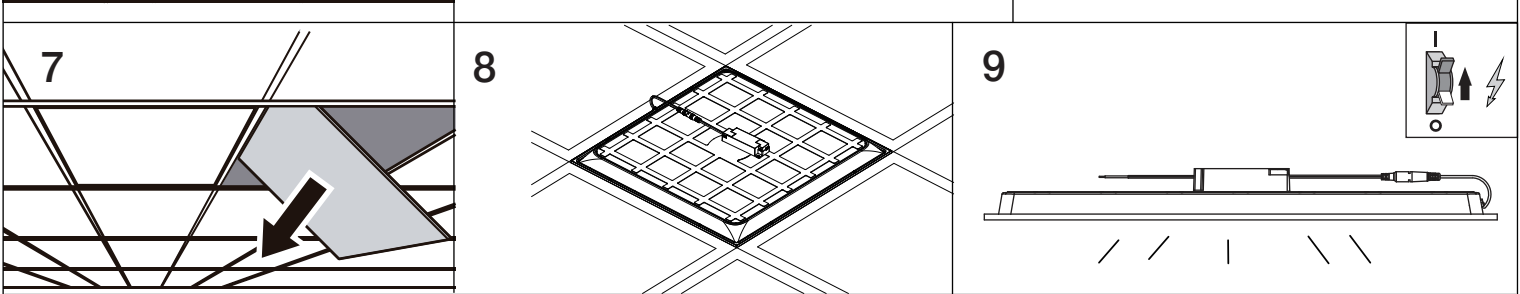
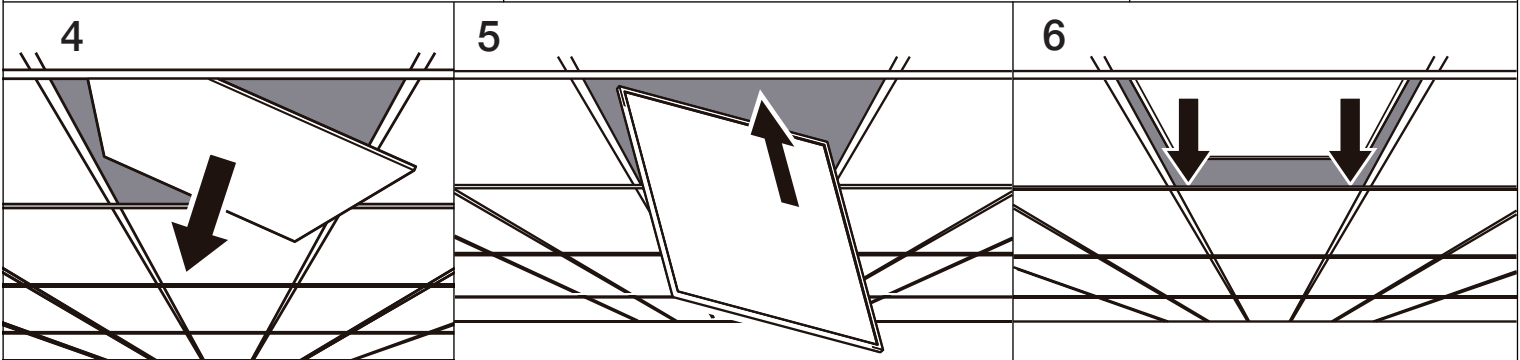
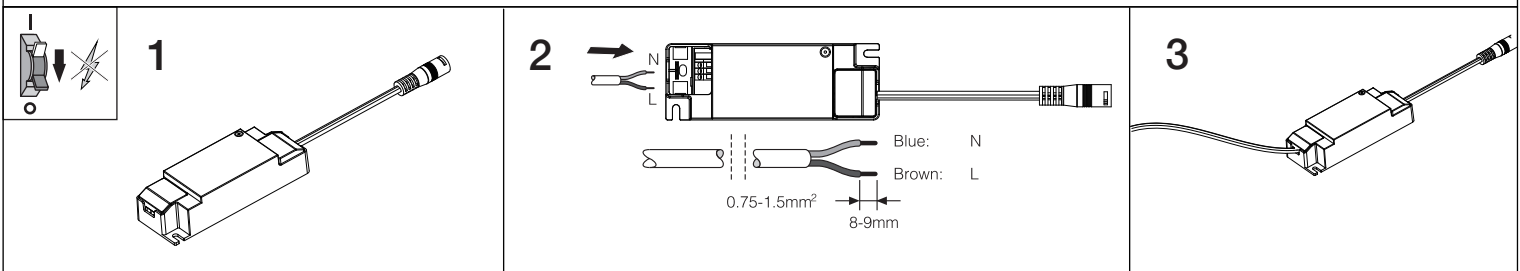
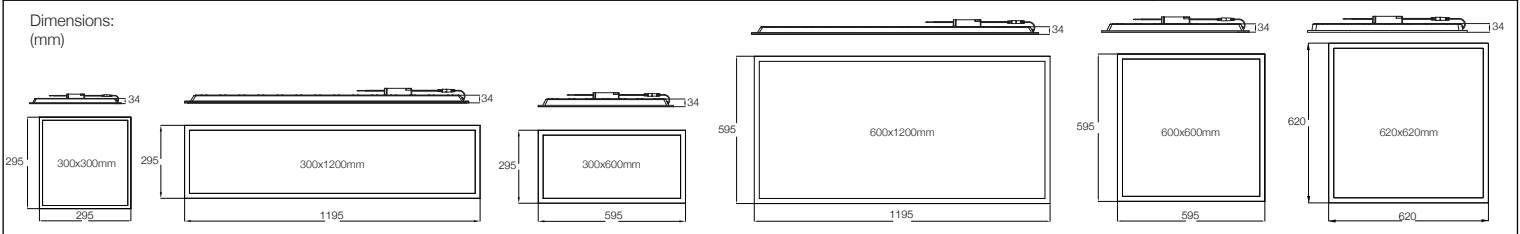

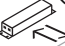

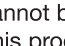
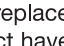

Content:	EAN	W	lm	K	R <sub>a</sub>	T <sub>a</sub> (°C)	Vac	Hz	kg
 1x  1x 	8719157049795	28	2800/3360/3000	3000/4000/6500	>80	-20...+40	220-240V	50/60Hz	1.40
	8719157049801	28	2800/3360/3000	3000/4000/6500	>80	-20...+40	220-240V	50/60Hz	1.70
	8719157049818	28	2800/3360/3000	3000/4000/6500	>80	-20...+40	220-240V	50/60Hz	1.54
	8719157049825	28	2800/3360/3000	3000/4000/6500	>80	-20...+40	220-240V	50/60Hz	1.86
	8719157049832	28	2800/3360/3000	3000/4000/6500	>80	-20...+40	220-240V	50/60Hz	1.64
	8719157049849	28	2800/3360/3000	3000/4000/6500	>80	-20...+40	220-240V	50/60Hz	1.90
	8719157049856	13	1200/1560/1300	3000/4000/6500	>80	-20...+40	220-240V	50/60Hz	0.50
	8719157049863	20	2000/2400/2100	3000/4000/6500	>80	-20...+40	220-240V	50/60Hz	0.90
	8719157049870	64	7000/7680/7500	3000/4000/6500	>80	-20...+40	220-240V	50/60Hz	3.00

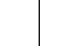
Inrush current	13W	20W	28W	64W	Remarks	Circuit Breaker
Driver	Noxion	Noxion	Noxion	Noxion		Item 13W 20W 28W 64W
Inrush current I peak (A)	3.76	11.9	28.8	45.8	Input voltage 230V	B16 142PCS 80PCS 33PCS 12PCS
Inrush current T width(μs)	34.4	134	138	222	Input voltage 230 V, measured at 50% I <sub>max</sub>	C16 142PCS 80PCS 49PCS 21PCS



⚠                   

# Accessories (must be ordered separately)

Please be aware that the backplane might be slightly different for each item.

<p><b>Removable Surface Mounted Kit</b></p>	<p><b>Suspension Kit</b></p>	<p><b>Mounting Clips</b></p>	<p><b>Security cable 1.5m</b></p>
---	------------------------------	------------------------------	-----------------------------------

## Removable Surface Mounted Kit 300X300,300X600,300x1200,600x600,620x620,600X1200

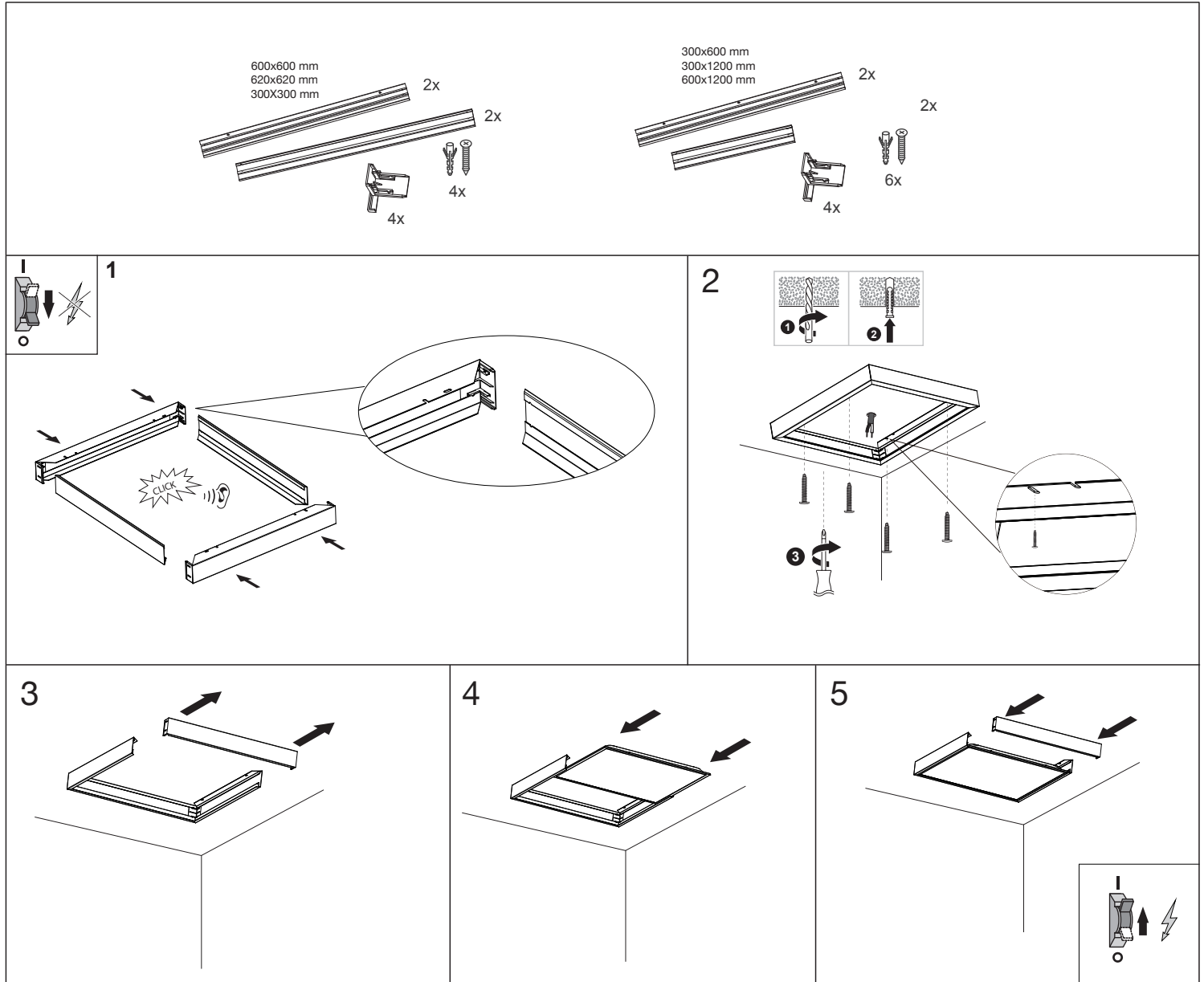

**EN** The luminaire shall be installed and maintained by a qualified electrician, in accordance with the national regulations in each country. The luminaire contains no replaceable parts. In case of the luminaire is damaged, it shall be exclusively replaced by the manufacturer or authorized dealer. Keep the operating manual for later use. The manufacturer is not responsible for the incorrect use and assembly of this product.

**NL** De armatuur dient te worden geïnstalleerd en onderhouden door een erkend installateur, in overeenstemming met de nationale regelgeving in het betreffende land. De armatuur bevat geen vervangbare onderdelen. Indien de armatuur is beschadigd dient deze enkel te worden vervangen door de fabrikant of door een erkende dealer. Bewaar de handleiding voor later gebruik. De fabrikant is niet verantwoordelijk voor onjuist gebruik en/of installatie van dit product.

**DE** Die Leuchte muss von einem qualifizierten Elektriker gemäß den nationalen Vorschriften in jedem Land installiert und gewartet werden. Die Leuchte enthält keine austauschbaren Teile. Falls die Leuchte beschädigt ist, wird sie ausschließlich durch den Hersteller oder den autorisierten Händler ersetzt. Bewahren Sie die Bedienungsanleitung für spätere Verwendung auf. Der Hersteller ist nicht verantwortlich für die unsachgemäße Verwendung und Montage dieses Produktes.

**FR** Le luminaire doit être installé et entretenu par un électricien qualifié, conformément à la réglementation nationale de chaque pays. Le luminaire ne contient pas de pièces remplaçables. Dans le cas où le luminaire est endommagé, il doit être remplacé exclusivement par le fabricant ou le revendeur agréé. Conservez le mode d'emploi pour une utilisation ultérieure. Le fabricant n'est pas responsable de l'utilisation et du montage incorrects de ce produit.

**IT** L'apparecchio deve essere installato e mantenuto da un elettricista qualificato seguendo le normative nazionali di riferimento. L'apparecchio non contiene parti sostituibili. In caso di rottura sarà sostituito esclusivamente dal produttore o da un rivenditore autorizzato. Conservate il manuale di installazione per eventuali utilizzi successivi. Il produttore non è responsabile per l'utilizzo ed il montaggio non corretto di tale apparecchio.

**ES** La luminaria debe de ser instalada y mantenida por un electricista cualificado, siguiendo las regulaciones nacionales de cada país. La luminaria contiene partes no reemplazables. En el caso de que la luminaria sea dañada, deberá ser reemplazada exclusivamente por el fabricante o distribuidor autorizado. Guarde el manual para usos posteriores. El fabricante no es responsable por el uso e instalación incorrecta de este producto.

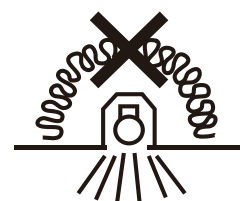

# Accessories (must be ordered separately)

## Suspension Kit

**1** **2** **3**

**4** **5** **6**

Panel Size (mm)	Ca.L (mm)
300x300	173
300x600	315
600x1200	471.5
600x600 / 620x620	288
300x1200	484

2x  
4x  
8x ST 3.2  
6x Ø 6  
6x ST4

ceiling  
Ca.L (mm)  
35 mm  
Ø 6 mm

ceiling  
Ca. 100 mm - 1450 mm

## Mounting Clips

**1** **2** **3**

4x  
8x ST 3.5

ceiling  
Ca. A (mm)  
Ca. B (mm)

	A X B
600x600/620x620	580 X 580
300x1200/600x1200	280 X 1180
300x300	280 X 280
300x600	280 X 580

## Security cable 1.5m

**1** **2** **3**

1x  
1x  
2x ST 3.2

90°

**!** **EN** Install the hook (not provided) on a sound surface and perfectly anchored to carry the weight. **NL** Installeer de haak (niet meegeleverd) in een solide ondergrond en perfect verankerd om het gewicht te dragen. **DE** Installiert den Haken (nicht mitgeliefert) auf einer soliden Oberfläche verankert und perfekt, um das Gewicht zu tragen. **FR** Installez le crochet (non fourni) sur une surface solide et parfaitement ancrée à supporter le poids. **ES** Instale el gancho (no incluido) en una superficie sólida y perfectamente anclado para soportar el peso.

